

Massage Motor

VM01

VM01 massage motor is an optional accessory for bed application to go with MOTECK control unit, such as double motor TW61-RMS. There are two types of fixtures available for customers to choose, which makes it able to be fixed on different frame design easily.



Features and Options

Main application: Furniture

Standard features:

- Input voltage: 24V DC
- Max. current: 0.5A @ 24V DC
- Motor speed: 1500rpm
- Duty cycle: 10%, 30 min. max.
- Lifetime: 600 hours
- Color: Black
- Overheat protection with PTC thermistor
- Cable length: 2000mm straight
- Certified: CE Marking, EMC Directive 2014/30/EU

Options:

- Fixture for board type / Fixture for slat type

Dimensions

With fixture for board type

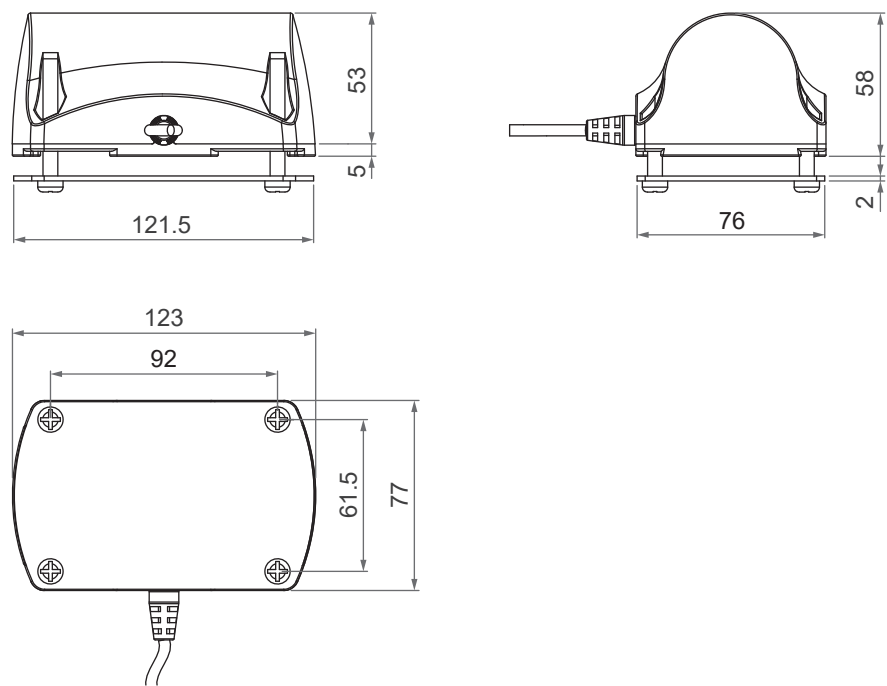

With fixture for slat type

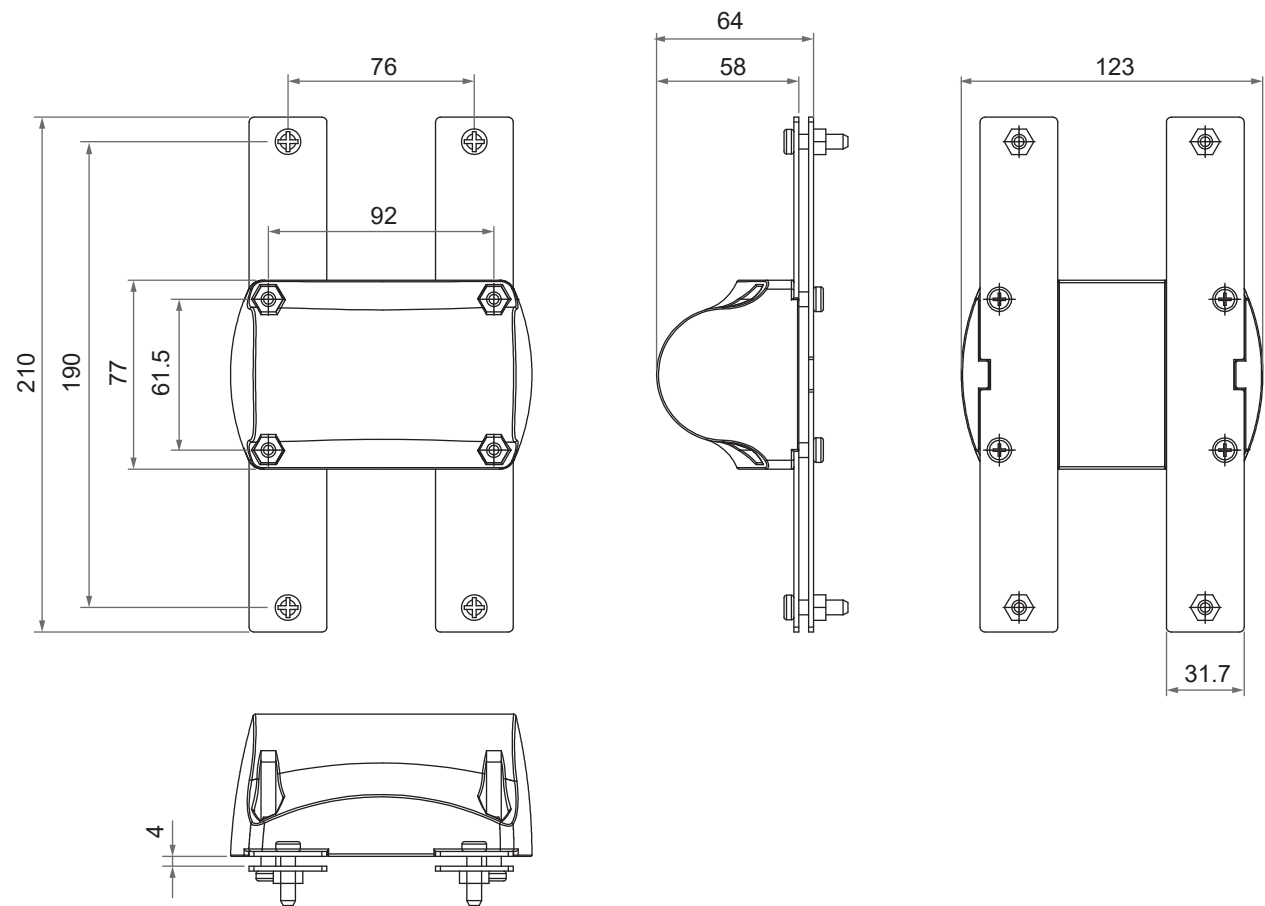

Unit: mm

Compatibility

| Prouduct | Model | Compatible requirement |
|--------------|----------|---|
| Double motor | TW61-RMS | With Moteck A2-type DIN 41529 plug (Fig. 1) |

Cable plug



Fig. 1 A2-type plug

Certifications

VM01 massage motor is compliant with the following regulations, in terms of the essential conformity requirements of EMC Directive of 2014/30/EU.

| Emission | Immunity |
|--|---|
| EN 55014-1:2017+A11:2020 BS EN 55014-1:2017+A11:2020 CISPR 14-1:2016-COR1:2016 | EN 55014-2:2025 BS EN 55014-2:2015 CISPR 14-2:2015 Catagory IV |

Ordering Key

| | | | | | | | |
|-----------------|--|------------------------|--|--|--|--|--|
| | | VM01- 24 - A 0 - 2 1 0 | | | | | |
| Input voltage | 24: 24V DC | | | | | | |
| Motor code | A: 1500rpm | | | | | | |
| Reserved | 0 | | | | | | |
| Cable plug | 2: With Moteck A2-type DIN 41529 plug, 2000mm straight | | | | | | |
| Fixture options | 0: None 1: Fixture for board type 2: Fixture for slat type | | | | | | |
| Reserved | 0 | | | | | | |

Terms of Use

The user is responsible for application suitability of Moteck products. As ongoing improvement process continues, products listed on the Moteck website are subject to change without prior notice. Moteck reserves the right to terminate the sales or remove any product displayed on the website, or listed in its catalogues.