

# Control Box

## T-control

T-control is a compact control box typically applies to furniture and home care beds. The control box possesses high compatibility to various wired and wireless controls and is designed to be easily mounted on FD60 actuator or other flat surface with a mounting plate.



### Features and Options

---

- Main applications: Furniture, Home care
- Input: 100 / 120 / 230V AC (EI transformer), 100~240V AC 50/60Hz (SMPS)
- Output voltage: 24V DC (EI transformer), 29V DC (SMPS)
- Output rated current: 3.0A in total
- Max. number of actuators: 3 channels
- Max. number of controls: 1 channel
- Duty cycle: 10%, max. 2 min. continuous operation in 20 min.
- Over-current protection function
- Emergency lowering against power outage, to retract actuators with 9V batteries (not included)
- Color: Black, grey RAL 7001
- Electric shock protection level: Class II
- Power cord: 3000mm
- Mounting: Attached to FD60 actuator or assembly with mounting plate to fix the wall (refer to Dimensions)
- Certified:
  - CE Marking, EMF EN62233 (for T230-24-3, TIS2 internal SMPS only)
  - CE Marking, EMC Directive 2014/30/EU, LVD Directive 2014/35/EU (for TIS2 internal SMPS only).
  - PSE Marking

## Dimensions

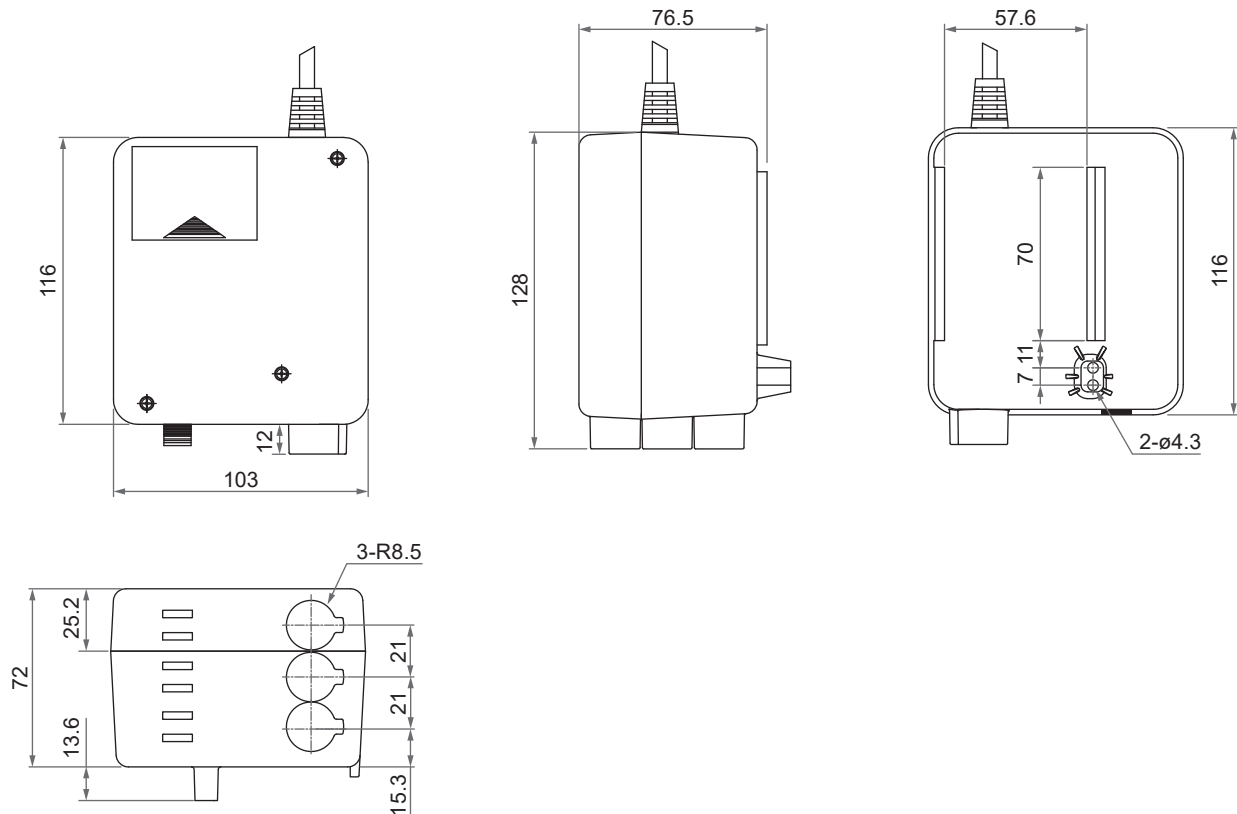

### • Assembly with plastic mounting plate

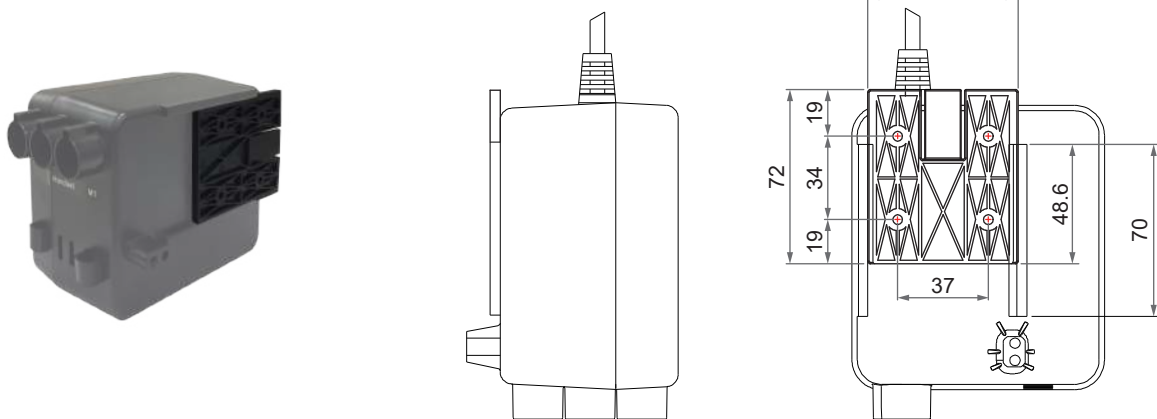

### • Assembly with metal mounting plate

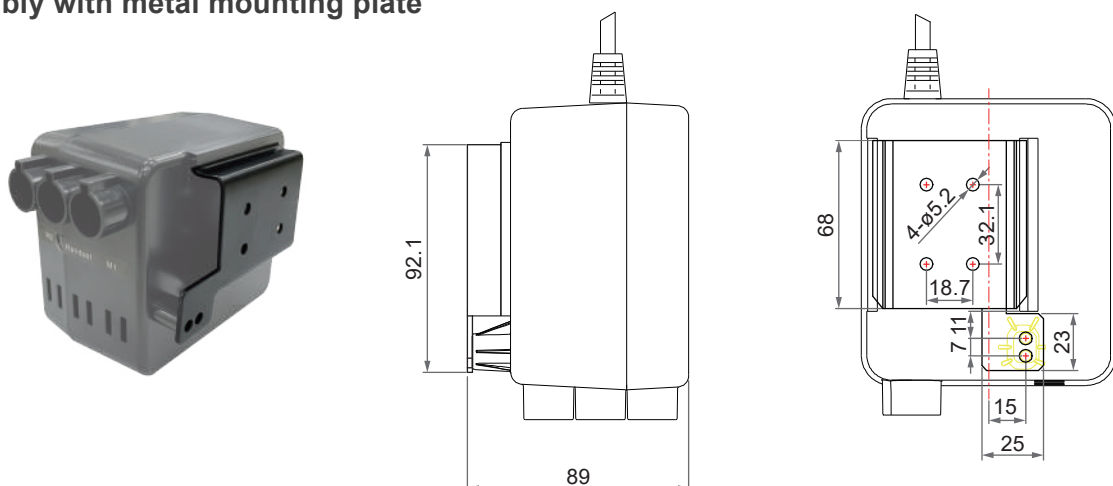

Unit: mm

## I/O Introduction

- 3 drives model

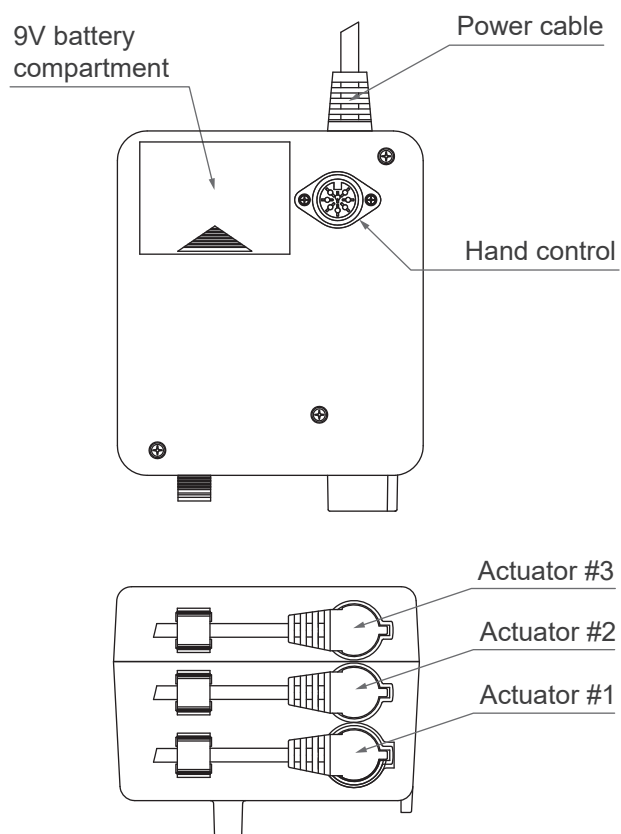

- 2 drives model

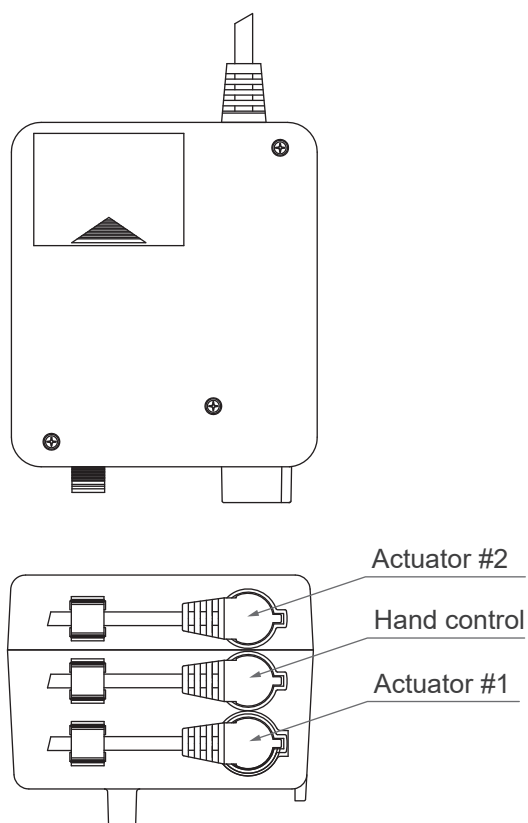

- 1 drive model

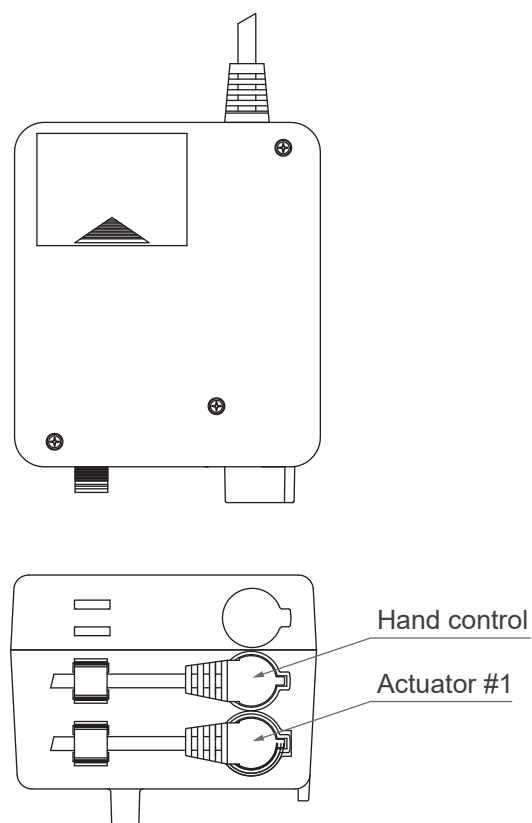

# Compatibility

Product	Model	Compatible requirement
Actuator	BD61, BD62, FD40, FD60*, FD61, GD70	<ul style="list-style-type: none"> <li>Without positioning sensors</li> <li>With Moteck F-type DIN plug</li> </ul>
Hand control	DKP4, DP05, DP11, HDU, HR, HD, HJ, HM, H2N, H2Z, H3NT	<ul style="list-style-type: none"> <li>Moteck P1 control category</li> <li>With Moteck F-type DIN plug</li> </ul>
Wireless option	TXA 2.4GHz RF adapter	<ul style="list-style-type: none"> <li>Moteck P1 control category</li> <li>With Moteck F-type DIN plug</li> </ul>

**\* Remarks:**  
T-control box can be attached to FD60 actuator.



T-control + FD60

## Socket

### Hand control socket for Moteck F-type DIN plug

- 3 drives model
- 1 drive model / 2 drives model

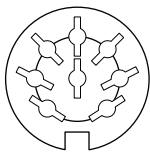

8-pin socket

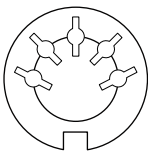

5-pin socket

### Actuator socket for Moteck F-type DIN plug

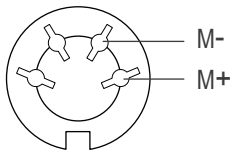

4-pin socket



F-type plug

**Note:** Connect M+ to “Vdc +” & M- to “Vdc -“ of DC power to extend the motor.  
Switch the polarity of DC input to retract it.

## Ordering Key

**T IS2 - 29 - 3 - 0 B**

<b>Input</b>	<b>100:</b> 100V AC <b>120:</b> 120V AC <b>230:</b> 230V AC <b>IS2:</b> Internal SMPS (100~240V AC)
<b>Output voltage</b>	<b>24:</b> 24V DC <b>29:</b> 29V DC (SMPS)
<b>Number of actuators</b>	<b>1:</b> 1 channel <b>2:</b> 2 channels <b>3:</b> 3 channels
<b>Mounting</b>	<b>0:</b> Attached to FD60 actuator (standard) <b>1:</b> Assembly with plastic mounting plate <b>2:</b> Assembly with metal mounting plate
<b>Color</b>	<b>B:</b> Black (standard) <b>G:</b> Grey RAL 7001



For more information about operating guide, refer to the respective product data sheets of the control devices connected.

## Safety Declaration

---



- Only qualified personnel are allowed to carry out the mechanical and electrical installation of this product. Qualified personnel should be familiar with the mechanical or electrical installation work and have corresponding work qualifications.
- This appliance is not intended for use by persons (including children) with reduced physical, sensory or mental capabilities, or lack of experience and knowledge, unless they have been given supervision or instruction concerning use of the appliance by a person responsible for their safety.
- Children should be supervised to ensure that they do not play with the appliance.
- Cleaning and user maintenance shall not be made by children without supervision.
- If the supply cord is damaged, it must be replaced by the manufacturer, its service agent or similarly qualified persons in order to avoid a hazard.
- The device should be securely installed and fixed using reliable mechanical methods on hard materials such as metal or plastic.

---

### Terms of Use

The user is responsible for application suitability of Moteck products. As ongoing improvement process continues, products listed on the Moteck website are subject to change without prior notice. Moteck reserves the right to terminate the sales or remove any product displayed on the website, or listed in its catalogues.