

# Control Box

## CM41

The CM41 control box can operate 4 actuators and support 2 actuators to operate at the same time, if the stop button is connected, all actuators can be stopped in case of emergency, mainly used in medical beds.



### Features and Options

---

- Main applications: Home care, medical
- Input: 100 ~ 240V AC, 50/60Hz (SMPS)
- Standby power: <0.5 W
- Output: 32V DC, 5A@110V or 8A@240V
- Max. number of actuators: 4 channels
- Number of control: 1 channel
- Duty cycle: 10%, maximum 2 minutes continuous use.
- Ambient operation temperature: +5°C~+40°C
- IP Protection level: IPX6
- Protection class against electric shock: Class II (with functional earthing)
- Color: Light gray RAL 7035
- Power cord length: 3000mm straight
- The default standard mounting plate can provide flexible installation methods (Refer to p.2, 6)
- Optional mounting clip, can attach to MK31 or MK31-QR actuators (Refer to p.2, 6)
- Optional function supports an external BTP3 battery box (items purchased separately)
- Optional function supports an external SB1 stop button (items purchased separately)

## Dimensions

- With Mounting Plate

Unit: mm

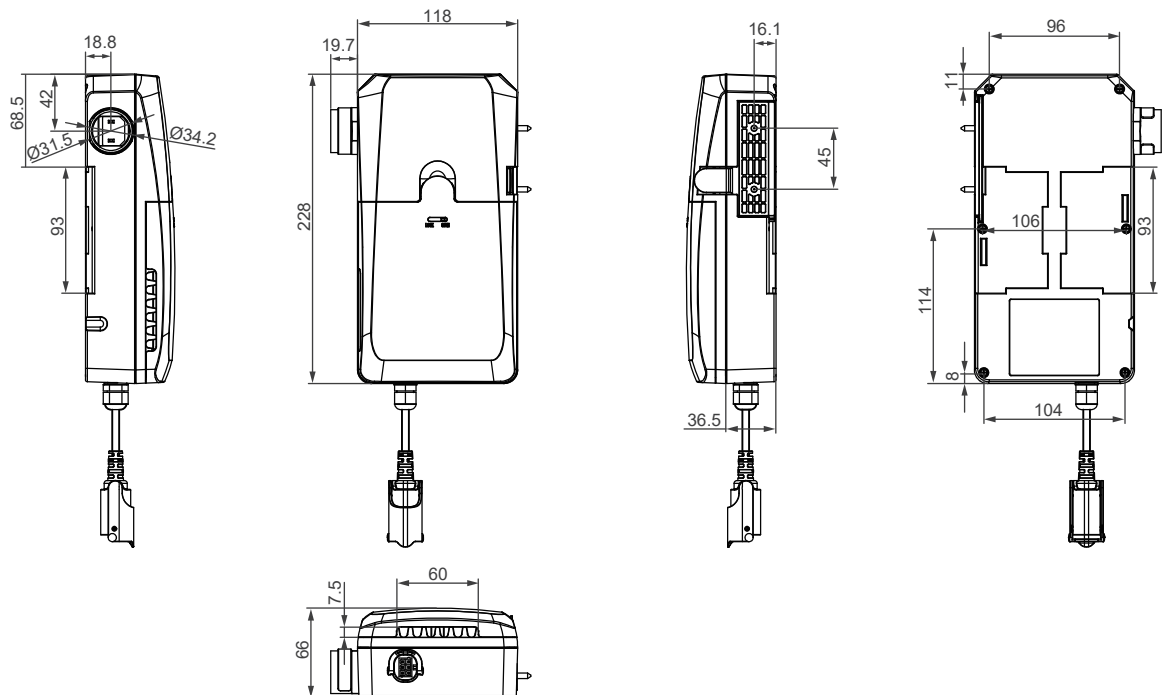

- Attach to MK31-QR actuator with Mounting Clip

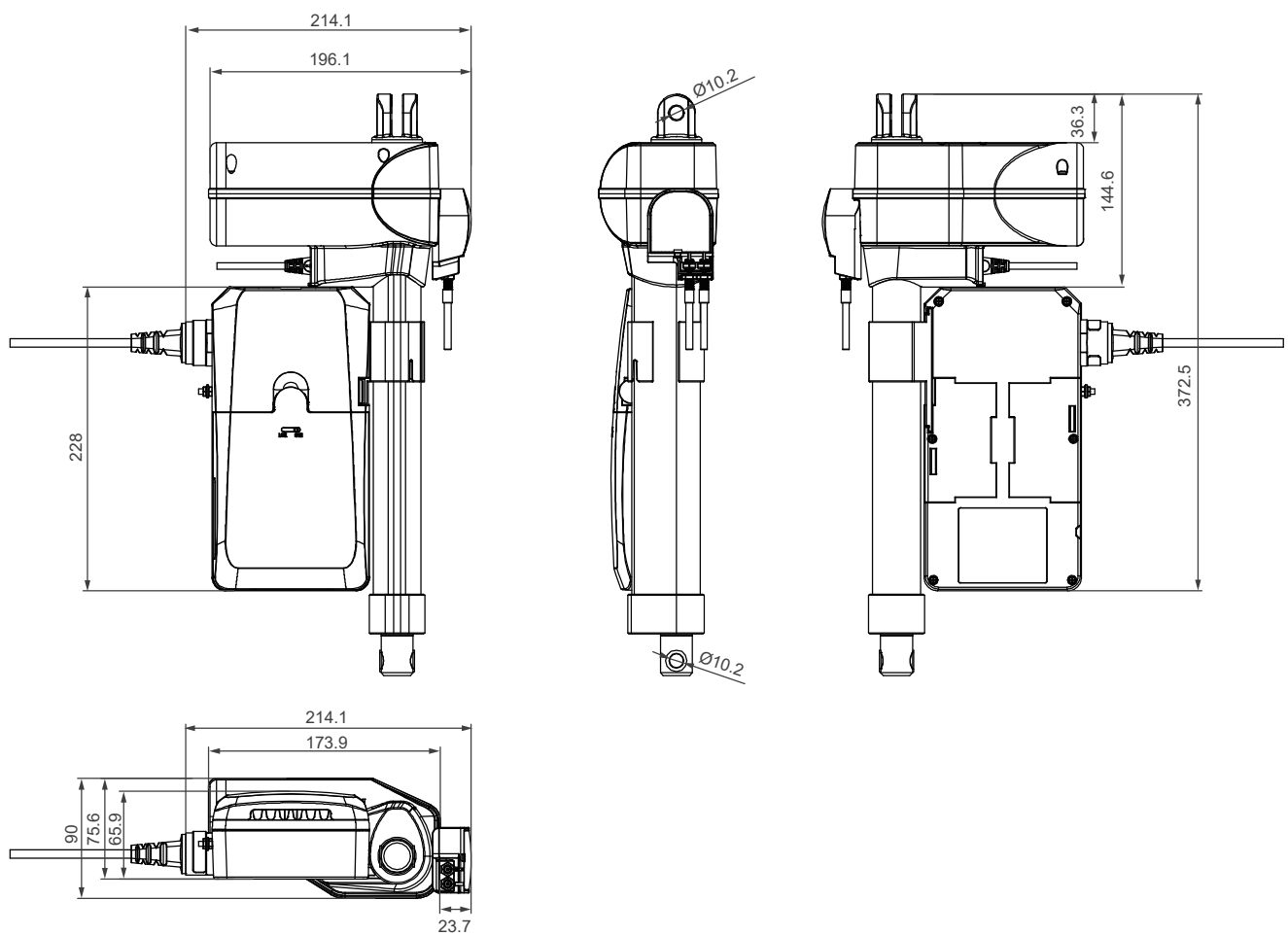

## Compatibility

Product	Model	Compatible requirement
Actuator	MD10, MD21, MD66, MD7, MD82, MK32, MK31, MK31-QR, MK33, MK67, LD60	- Without positioning feedback sensors - With Moteck LR-type minifit 6-pin plug
Hand control	FS1, FS2, FS3, H3T, HF, HS12, HT	- Moteck P1 control category - With Moteck V-type 8-pin DIN plug
Battery Box	BTP3	- With Moteck L6-type minifit 4-pin plug
Stop button	SB1	- With Moteck LS-type minifit 6-pin plug

## Socket

**Actuator socket: for Moteck LR-type minifit 6-pin plug**

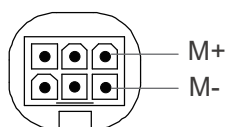

6-pin socket

**Hand control: for Moteck V-type 8-pin DIN plug**

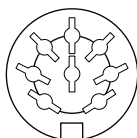

8-pin socket

**External battery box: for Moteck L6-type minifit 4-pin plug**

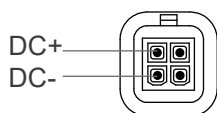

4-pin socket

**Stop button: for Moteck LS-type minifit 6-pin plug**

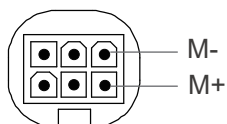

6-pin socket



LR-type



V-type





L6-type

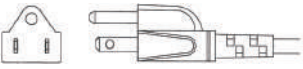
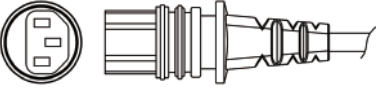
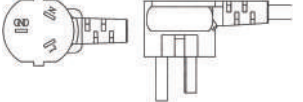

LS-type

# AC Power Cord

Plug type (plug in the wall)	Connector type (plug in the control box)
<b>A3:</b> US 3-pin plug 	<ul style="list-style-type: none"><li>• AC power cord length: 3000mm straight</li></ul>
<b>C3:</b> CHINA CCC 3-pin plug 	
<b>V3:</b> CEE 7/7(VDE 3P) plug 	

# I/O Introduction

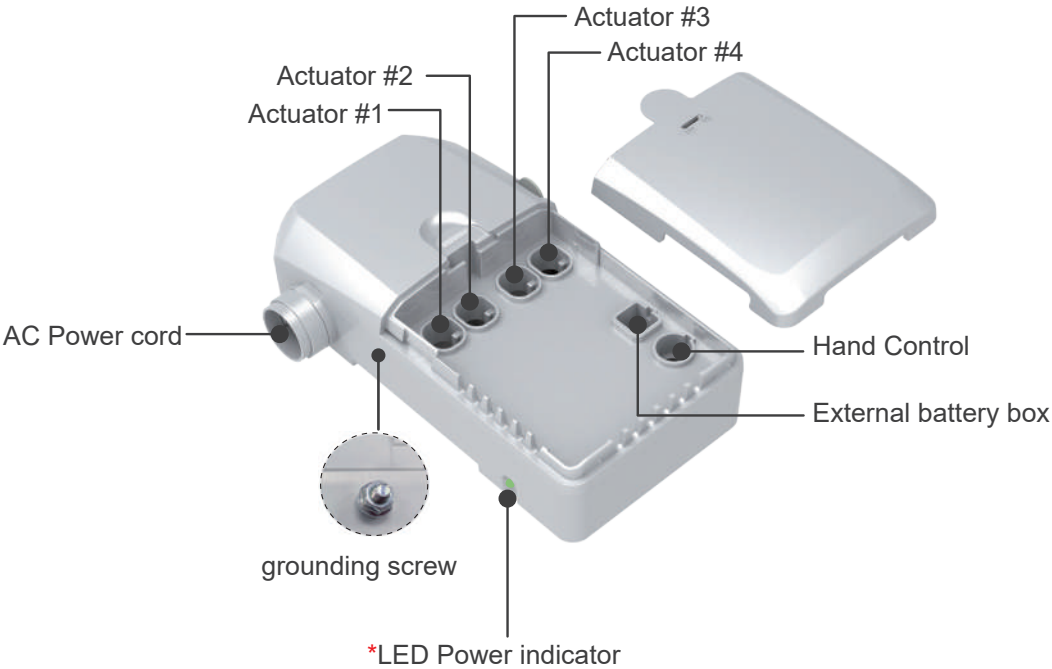

## Remarks:

\* When the control box is connected to AC power, the LED power indicator lights up green, if it is only connected to an external battery, the LED power indicator is off.



## Ordering Key

**CM41-32 D-2-S B P A3**

<b>Output voltage</b>	<b>32:</b> 32V DC
<b>Power supply</b>	<b>D:</b> Internal SMPS (32V DC, 5A)
<b>Number of actuators</b>	<b>2:</b> 2 actuators <b>3:</b> 3 actuators <b>4:</b> 4 actuators
<b>Stop Button</b>	<b>0:</b> None <b>S:</b> Support (separately purchased item)
<b>External battery box</b>	<b>B:</b> Support (separately purchased item)
<b>Accessory</b>	<b>P:</b> Mounting Plate <b>C:</b> Mounting Clip
<b>AC Power cord</b>	<b>A3:</b> US 3-pin plug, 3000mm straight <b>C3:</b> CHINA CCC 3-pin plug, 3000mm straight <b>V3:</b> CEE 7/7(VDE 3P) plug, 3000mm straight <b>00:</b> Without AC Power cord

## Installation

### - Mounting Plate:



Mounting Plate

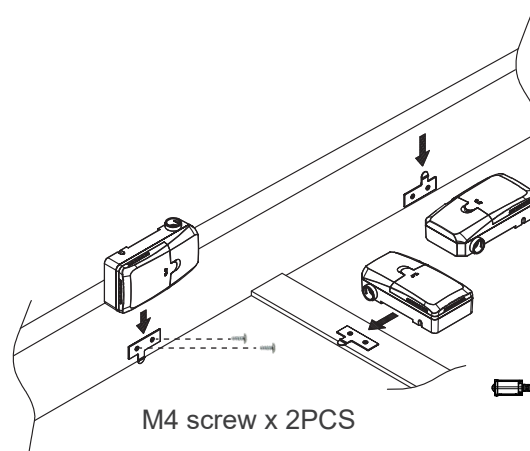

Fig.1

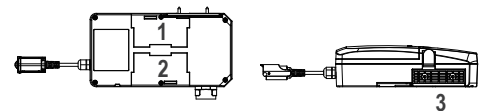

Fig.2

1. As shown in **Fig.1**, the above installation directions are available
2. According to the usage, first fix the mounting plate to the proper position of the bed frame with M4 screws. (**Fig.1**)
3. Align the mounting plate with notch (1~3) on the back of the control box and put it in. (**Fig.1, 2**)

### - Mounting Clip:



Mounting Clip



1. Put the mounting clip into the MK31-QR actuator first.
2. Then follow the notch of the control box and insert it into the other end.

---

## - Anti-pull clip for AC cable

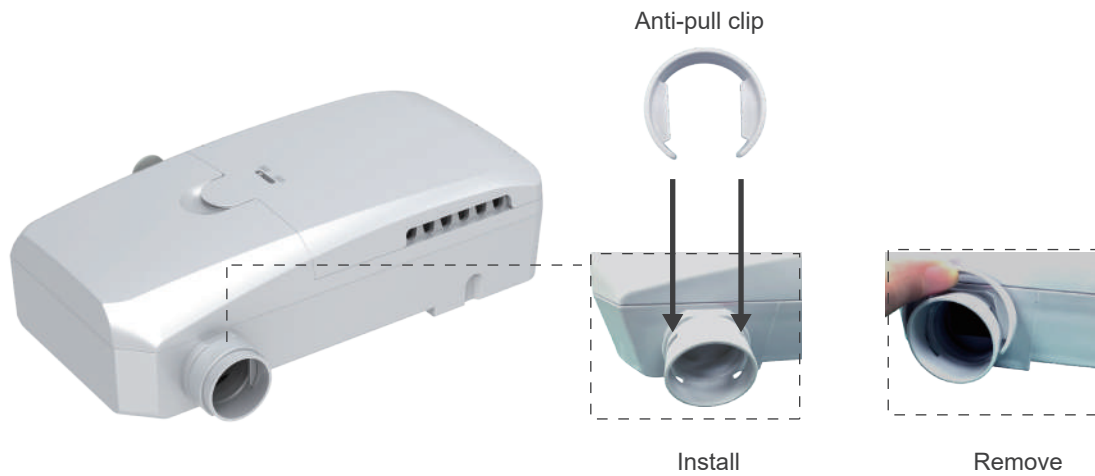

1. Install: Align the latches on both sides of the socket and insert the anti-pull clip
2. Remove: Pull the anti-pull clip upward to remove it

## - OPEN anti-pull cover



1. Set the lock to **OPEN**.
2. Slide the upper cover out to the end and lift to remove it.

---

- Put anti-pull cover back



1. Please see the figure above for the recommended cable management. Please refer to I/O Introduction for port layout.

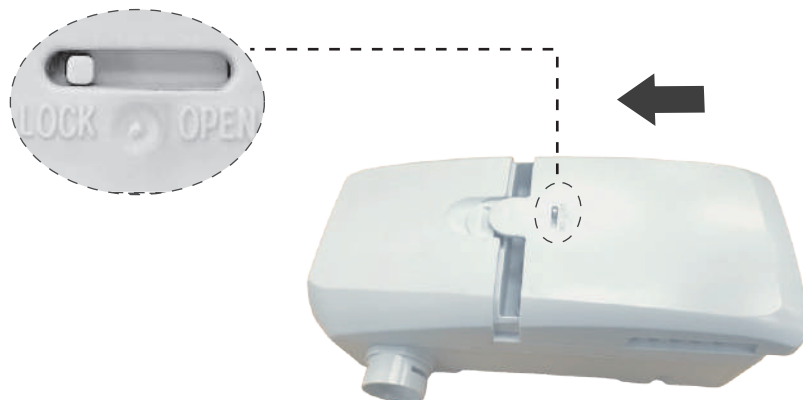

2. Place the anti-pull cover to align the opening of the chute, and slide it to the bottom and hook it.
3. Set the lock of anti-pull cover to **LOCK** position.

---

**Terms of Use**

The user is responsible for the suitability of MOTECK products, and the products listed on the MOTECK website are subject to change without notice. MOTECK reserves the right to terminate sales or delete any products displayed on the website or listed in its catalog.