

Control Box

CBP3

The CBP3 control box is specially designed for patient hoists and stand-up lifts. The LCD panel on the control box can display error codes and pictograms, which is convenient for after-sales service providers to serve users.

In addition, the control box will automatically record the cumulative operating time of the actuators, or the occurrence of abnormal usage events such as overheating and overloading. The after-sales service provider can connect the CBP3 control box to the computer to read and download these records for analysis. Or the distributor can change some parameters through the computer setting to make the distribution operation more flexible.



Features and Options

• CBP3 Control Box

- Main applications: Medical, home care
- Input voltage: 100 ~ 240V AC, 50/60Hz (SMPS)
- Output voltage: 24V DC
- Overload protection current on lifting actuator: 5 ~ 9A (on demand)
- Charger: 29V/1A SMPS
- Max. number of actuators: 2 channels
- Max. number of controls: 1 channel
- Emergency stop button
- LCD display shows status info or error code
- Data collection of predefined abnormal use in memory chip
- Connecting with PC to read data collection and change settings with service tool software (for customer service purpose, not for end-user)
- Duty cycle: 10%, max. 2 min continuous operation in 20 min.
- IP Protection level: IP66 (internal SMPS charger) / IPX4 (external SMPS charger)
- Color: RAL 7035 (front cover), RAL 7016 (back cover)
- Power cord length: 3000 mm (internal SMPS charger) / 2800 mm (external SMPS charger)
- Certified: CE Marking, EN IEC 60601-1, EN IEC 60601-1-2
- Optional LED indication of charging and usage status
- Optional lead-acid battery (5.0Ah) inside
- Charge with CBP3 control box, or charge with CHP1 battery charger (optional)

● BTP1 Battery Pack

- Input voltage: 24V DC
- Output current: max. 10A
- Lead-acid battery (12V/5Ah x 2 pcs)



● CHP1 Battery Charger

- Input voltage: 100/120/230V AC
- Output voltage: 24V DC
- Output current: max. 800mA
- Color: RAL 7035 (front cover), RAL 7016 (back cover)
- Storage temperature: -20°C ~ 60°C
- Ambient operation temperature: +5°C ~ 40°C



Dimensions

• CBP3 Control Box+BTP1 Battery Pack

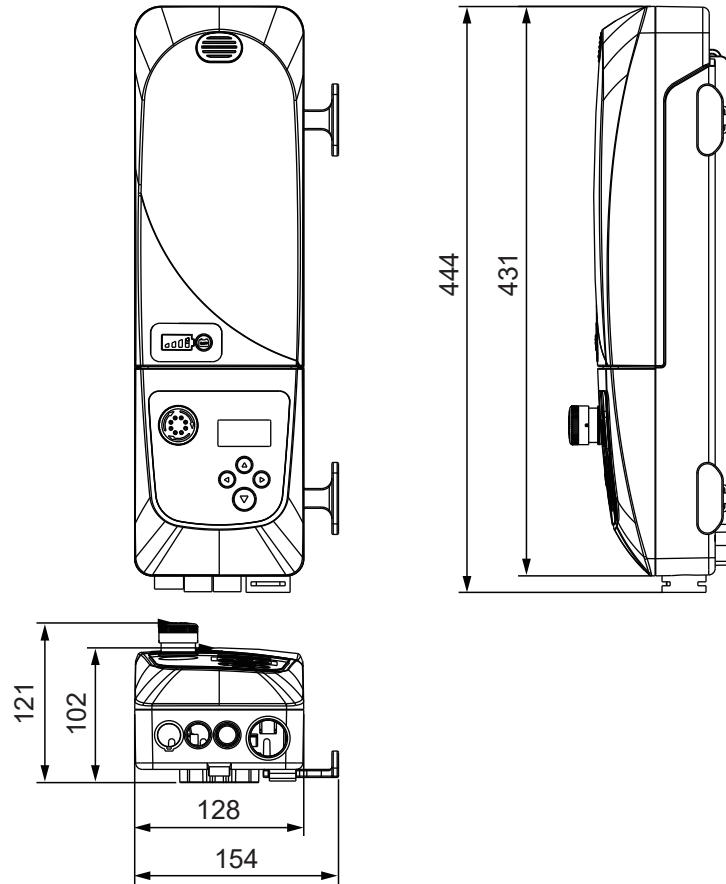

• CBP3 Control Box

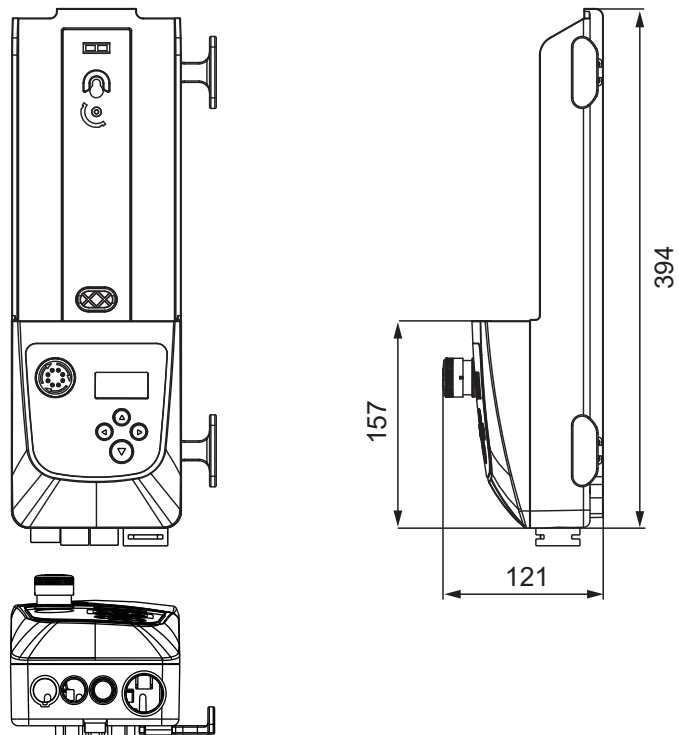

• BTP1 Battery Pack

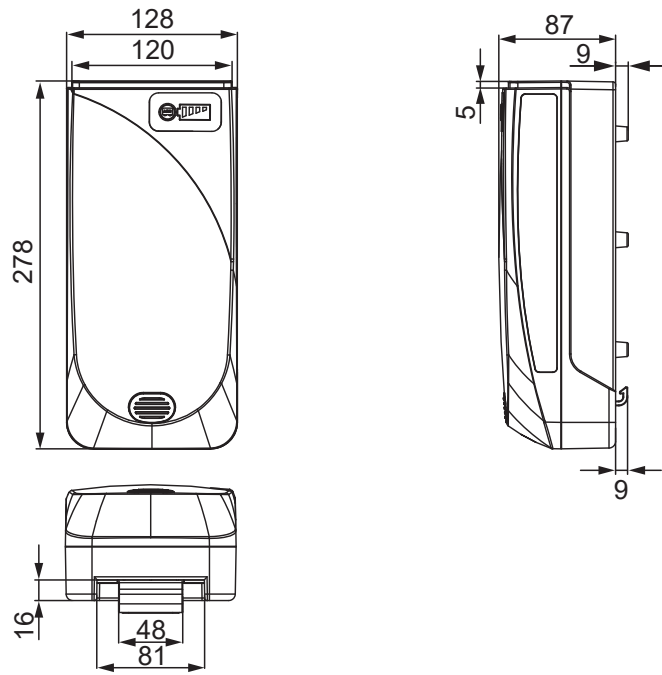

• CHP1 Battery Charger

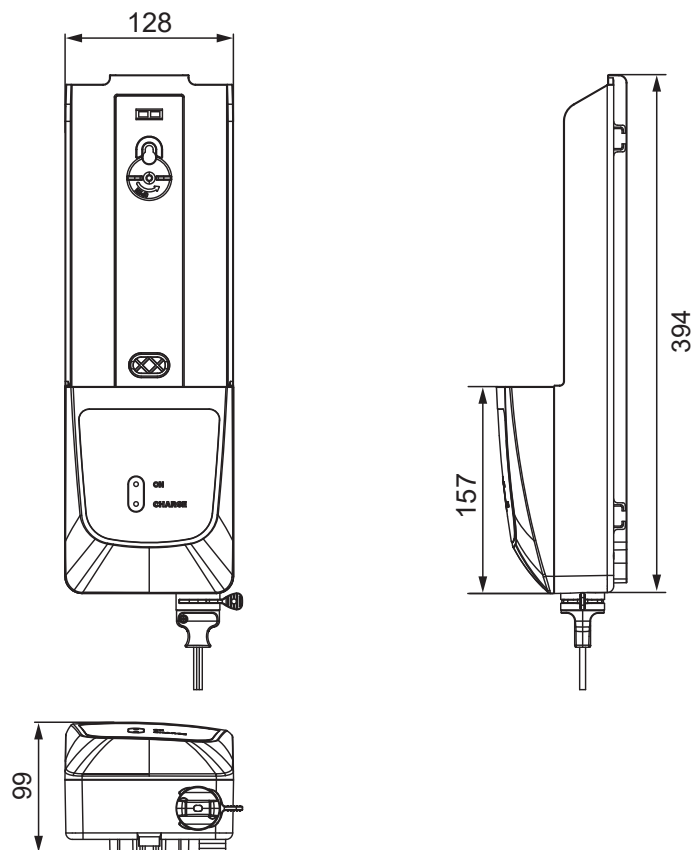

Compatibility

Product	Model	Compatible requirement
Actuator	Lifting actuator: MD60, MD80, MD82, MD100, MD120	- Moteck J1-type or J2-type plug
	U base legs spreading actuator: MD50	
Hand control	HTF, HT	- Moteck P2 control category - With 5-pin Moteck H-type DIN plug
	H2T (support battery level, overload alarm and service reminder indicator)	- Moteck S3 control category - With 8-pin Moteck H-type DIN plug
Accessory	BTP1 Battery pack	- Nil
	CHP1 Battery charger	- Nil

Socket

• Actuator socket

- Moteck J1-type

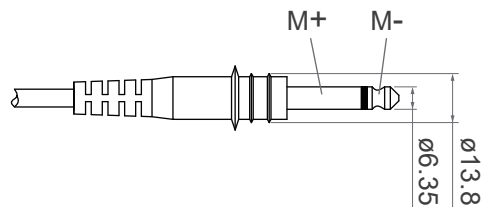

- Moteck J2-type

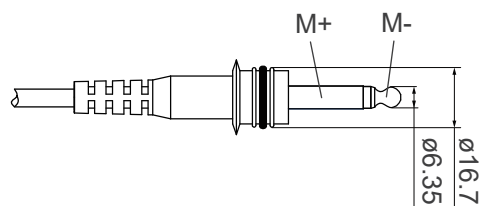

• Hand control socket

- Moteck H-type DIN plug

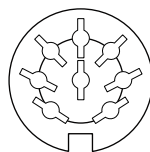

8-pin socket



J1-type

J2-type

H-type

I/O Introduction

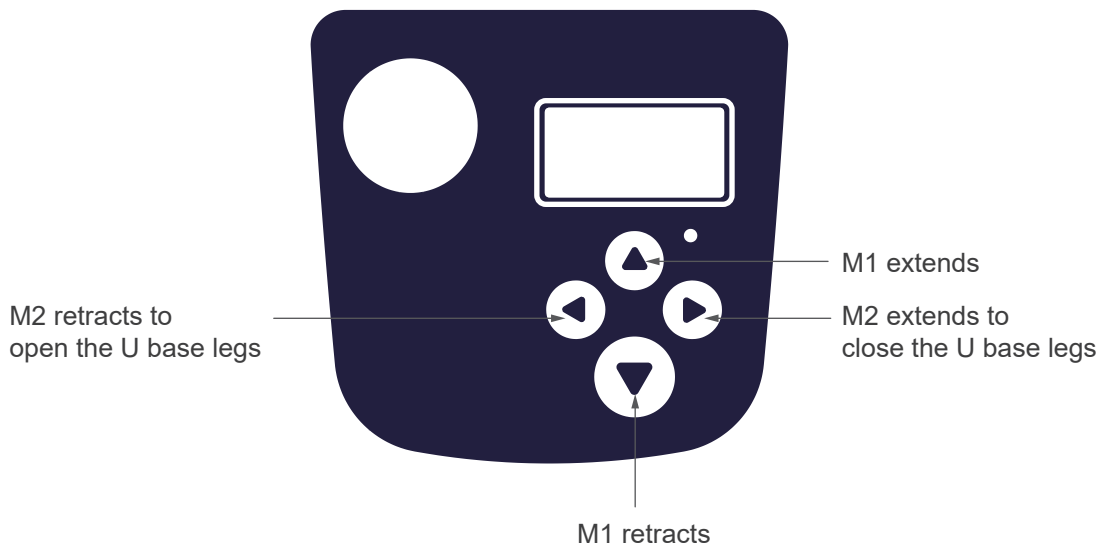
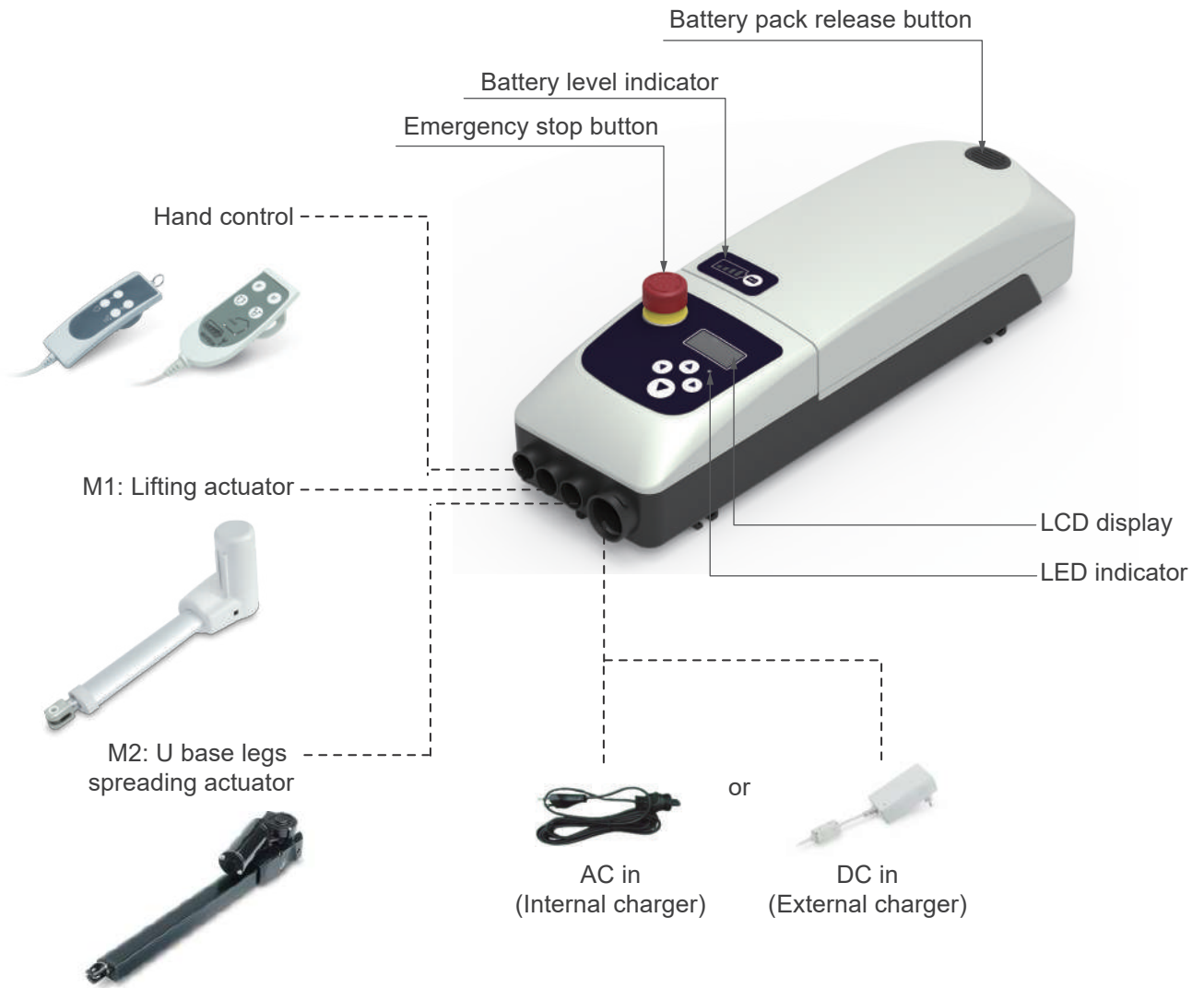

Ordering Key

CBP3 - 24 - 2 - 1 - A B V -

Output voltage	24: 24V DC
Number of actuator	1: 1 channel 2: 2 channels
Actuator socket	1: Compatible with Moteck J1-type (ø13.6mm) Phone jack 2: Compatible with Moteck J2-type (ø16.7mm) Phone jack
Firmware version	A: Version A (standard)
Battery pack	Blank: Without lead-acid battery and BTP1 battery pack B: With lead-acid battery inside (12V/5Ah x 2 pcs) 0: Without lead-acid battery inside
Battery level indicator	Blank: Without LED indicator and BTP1 battery pack V: With LED indicator 0: Without LED indicator
Charger	Blank: Internal SMPS charger (100 ~ 240V AC), with 3000mm straight power cord. T: External SMPS charger (100 ~ 240V AC), only europlug with 2800mm straight power cord available.

Terms of Use

The user is responsible for application suitability of Moteck products. As ongoing improvement process continues, products listed on the Moteck website are subject to change without prior notice. Moteck reserves the right to terminate the sales or remove any product displayed on the website, or listed in its catalogues.